

284 to 302 Waterloo Road · SE1 8RQ · London · United Kingdom
T +44 (0) 207 928 4062

h10.london.waterloo@h10hotels.com
www.hotelh10londonwaterloo.com

 @h10londonwaterloo

 @H10.London.Waterloo

Information and bookings:

T +34 900 444 466

reservations@h10hotels.com

www.h10hotels.com

 @h10hotels

 @H10.Hotels

 www.youtube.com/user/h10hotels

Setting

The **H10 London Waterloo** is located on the famous Waterloo Road in South Bank, just a 5-minute walk from Waterloo station. The hotel benefits from an exceptional location, very close to some of the city's main points of interest, such as the Houses of Parliament, Big Ben, Westminster Abbey and the London Eye.

Underground:

300 m/0.2 miles from Lambeth North station (Bakerloo line)

450 m/0.3 miles from Waterloo station (Jubilee, Bakerloo, Northern lines)

Train:

450 m/0.3 miles from Waterloo station

1.7 km/1.1 miles from Charing Cross station

2.7 km/1.7 miles from Victoria station

4.9 km/3.1 miles from King's Cross/St Pancras station (Eurostar)

Airports:

14 km/8 miles from London City airport

30 km/18 miles from Heathrow airport

46 km/29 miles from Luton airport

50 km/31 miles from Stansted and Gatwick airports

Tourist points of interest:

900 m/0.6 miles from the London Eye

2.2 km/1.4 miles from Big Ben/Houses of Parliament/Westminster Abbey

Coordinates: 51° 29' 55.9818" N / 0° 6' 22.6548" W

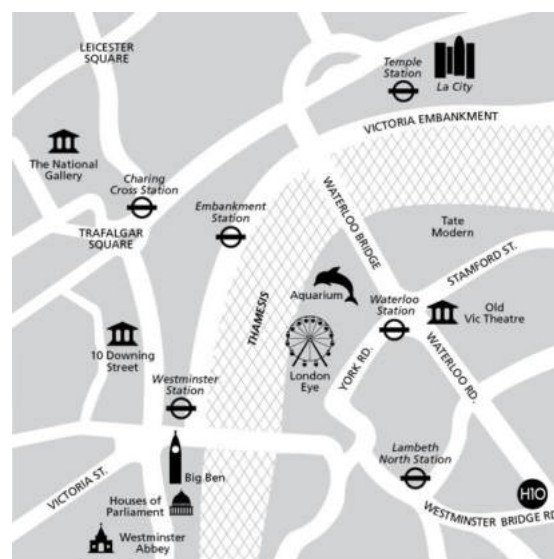

Description

With an unbeatable location close to Parliament, Big Ben, the London Eye and Tower Bridge, the **H10 London Waterloo** is a hotel with unique architecture in asymmetric shapes and an elegant interior design. It features bright and comfortable rooms, the Three O Two Restaurant and the exclusive Waterloo Sky Bar terrace with magnificent views of the city.

177 Rooms

Complimentary Wi-Fi throughout the hotel

Three O Two Restaurant*

Circus Bar*

Waterloo Sky Bar* on the 8th floor with magnificent views of the city
2 meeting rooms

*Restaurant and bar services are subject to changes depending on the season.



Rooms

The **H10 London Waterloo** has bright, modern rooms, with laminate wood flooring, that are equipped with all the amenities you could need for a comfortable stay:

42-inch LCD TV with international channels

iHome

Deluxe mattress topper

Complimentary umbrella

USB charger and international plug sockets

Minibar (\$ depending on consumption)

Kettle tray (restocked daily)

Complimentary in-room safe

Iron and ironing board

Climate control system

Fully-equipped bathroom with professional hairdryer, magnifying mirror and scales



DOUBLE ROOM

Double Rooms: elegant 19 m² rooms with windows overlooking the city. They feature a 1.80 x 2 m Queen Size bed or two 0.90 x 2 m twin beds.



CITY VIEW DOUBLE ROOM

City View Double Rooms: 19 m² Double Rooms with a 1.80 x 2 m Queen Size bed or two 0.90 x 2 m twin beds. They are located on the top floors of the hotel and come with large windows with panoramic views of the city. Bathrobe and slippers are available on request.



DELUXE DOUBLE ROOM

Deluxe Double Rooms: 25 m² rooms with large windows overlooking the city. They come with a 1.80 x 2 m Queen Size bed or two 0.90 x 2 m twin beds. In addition to the services offered in all the rooms, these rooms also offer the following:

50-inch Smart TV

Nespresso machine restocked daily with 100% compostable capsules

Bathrobe and slippers (on request)

Some **Deluxe Double Rooms** may include an additional bed to accommodate up to 3 adults.



LONDON EYE DOUBLE ROOM



London Eye Double Rooms: 19 m² Double Rooms located on the 9th floor with exceptional views of the London Eye. They feature a 1.80 x 2 m Queen Size bed and, in addition to the amenities available in the other rooms, they also offer:

- Welcome gift
- Complimentary bottle of cava
- 50-inch Smart TV
- Nespresso machine restocked daily with 100% compostable capsules
- Bathrobe and slippers



WATERLOO JUNIOR SUITE



Waterloo Junior Suite: an exclusive 30 m² room located on the 12th floor of the hotel. It comes with a 2 x 2 m King Size bed and large windows with magnificent views of the London skyline. In addition to the services available in other rooms, the Waterloo Junior Suite also benefits from the following:

- Welcome gift
- Complimentary bottle of cava
- 49-inch Smart TV
- Chester Sofa
- Nespresso machine restocked daily with 100% compostable capsules
- Bathrobe and slippers

Note: the décor, size and views of the rooms may vary depending on the room allocated.

Restaurants and bars



THREE O TWO

Three O Two: a modern, à la carte restaurant located on the 1st floor, with large windows overlooking the street. It features carefully prepared signature cuisine, specialising in Mediterranean gastronomy with a Spanish touch.*

*Breakfast service may be the only available service depending on the season, consult with the hotel for more information.



CIRCUS BAR

Circus Bar:* located in the hotel lobby, the Circus Bar's menu includes classic international cocktails, as well as light dishes such as salads and sandwiches.

*The Circus Bar may be closed depending on the season.

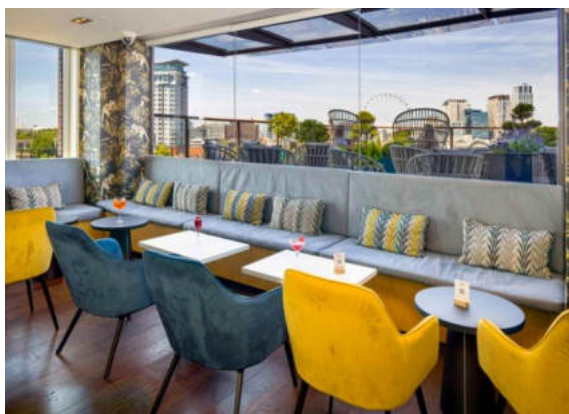

WATERLOO SKY BAR

Waterloo Sky Bar:* located on the 8th floor of the hotel, this bar includes a terrace with impressive views of the London skyline. It is the ideal place for enjoying a pleasant evening in a cosmopolitan atmosphere; it features trendy and classic international cocktails, as well as an interesting tapas menu.

*Bar service and access to the terrace may be unavailable depending on the season.



MEETINGS & EVENTS
H10 HOTELS

The **H10 London Waterloo** has two meeting rooms equipped with everything needed for business meetings. In addition, the Three O Two Restaurant, with natural light, offers an exclusive space for any type of celebration or event.

Spaces for events	m2	ft ²	Height	CAPACITY							
				Drinks reception	Theatre	Classroom	Boardroom	Banquet	Cabaret	U SHAPE	O SHAPE
OXFORD CIRCUS*	80	861	3 m	60	60	41	21	30	24	23	25
MARBLE ARCH	53	570	3 m	25	36	24	22	-	-	21	23
THREE O TWO RESTAURANT	269	2895	3 m	240	-	-	80	120	-	-	-

*There is a pillar on the left side of the room. Maximum capacity (optimal) recommended for these rooms by event type.

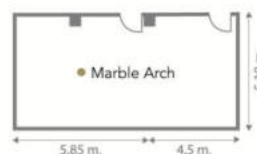
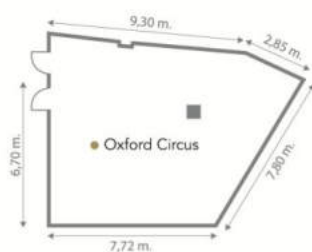
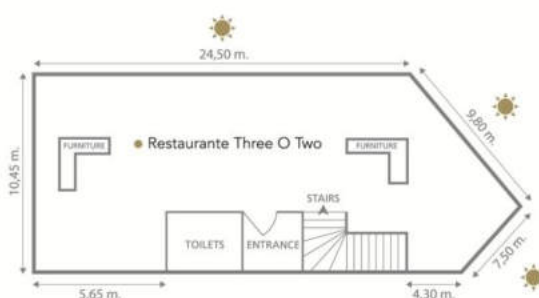



OXFORD CIRCUS ROOM – U-SHAPE SETUP



OXFORD CIRCUS ROOM – U-SHAPE SETUP



DRINKS RECEPTION IN THREE O TWO

perfect day
Weddings
& Celebrations

At the **H10 London Waterloo**, we take care of every detail so your celebration turns out just how you dreamt it would. The hotel offers fine signature cuisine and professional, personalized treatment, as well as unique spaces for dinners or private events.



BANQUET IN THREE O TWO



BANQUET IN THREE O TWO

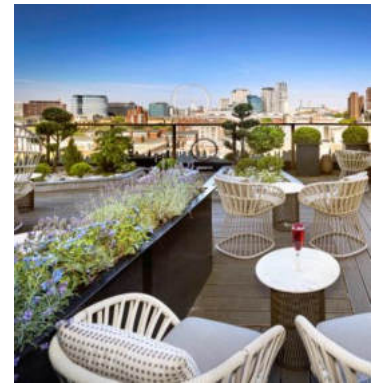

WATERLOO SKY BAR

GDS

SABRE: WV 24409
APOLLO/GALILEO: WV 5827
WORLDSPAN: WV 46182
AMADEUS: WV LON182
PEGS ADS / TRAVELWEB: WV 102634

Quality Certificates



Awards

TRIPADVISOR	Travellers' Choice – 2023, 2021, 2020 Certificate of Excellence – 2019, 2018, 2017, 2014, 2013 H10 HOTELS is recognized by Tripadvisor as one of the ten “most excellent” medium-sized hotel chains in the world. – 2018
BOOKING.COM	Traveller Review Award – 2023, 2022, 2021, 2020 Booking Award – 2018
HOLIDAYCHECK	Recommended – 2017 Holidaycheck Award – Urban Travel Category Award – 2014, 2013 Holidaycheck Award – 2013 Quality Selection – 2013
TRIVAGO	Trivago Awards – Best breakfast – 2017
LUKAS LATIN AWARDS	Spanish Restaurant of the Year – 2014
GRAN HOTEL TURISMO MAGAZINE	Best Hotel Chain 2014 at the 10 th Hotel Initiative Awards – 2014
ZOOVER	Top 5 Hotel in England – 2013
LATEROOMS.COM	Top 10 Business Hotel – 2013 Simply the Guest Awards – Top Rated – 2013
TRAVEL REPUBLIC	Customer Recommendation Awards – 2011
RIBA (ROYAL INSTITUTE OF BRITISH ARCHITECTS)	National Architecture Award – 2011
NLA NEW LONDON AWARDS	Architecture Award – 2011
H10 HOTELS	1 st Prize for Excellence – 2010
HOTELS.COM	Loved by Guests - 2021



At H10 Hotels, we are committed to the environment, which is why **Stay Green** was created. This sustainability project aims to develop a responsible business model based on three primary lines of action: the elimination of plastics and waste reduction, energy efficiency and the use of green energy, and training and awareness programmes for both our employees and our guests.